

DO NOT SCALE

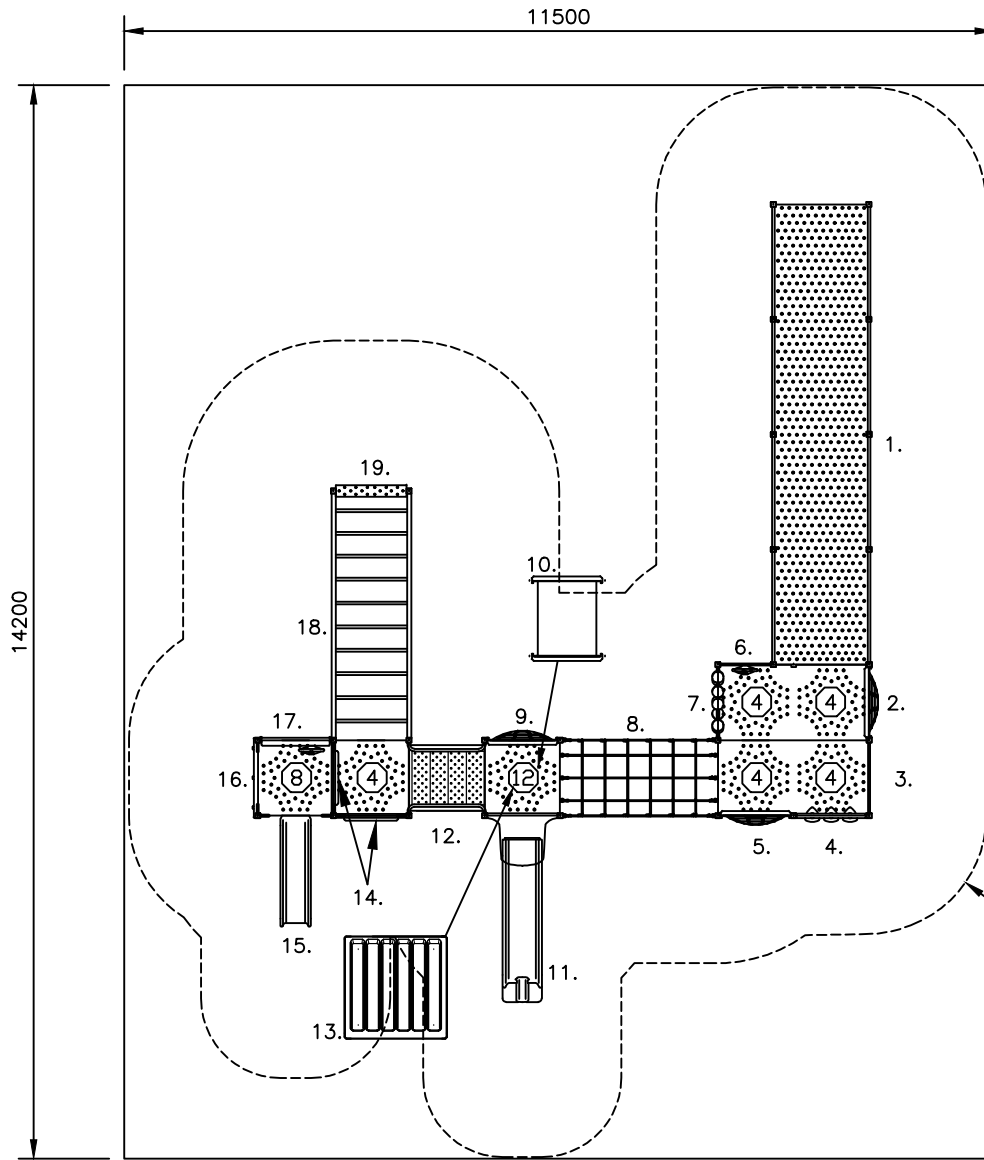

1. ACCESS RAMP
2. EYE SPY PANEL
3. SAFETY RAIL PANEL
4. NAUGHTS & CROSSES PANEL
5. MAZE PANEL
6. SAFETY RAIL PANEL & WHEEL (HALF)
7. ABACUS PANEL
8. INCLINED ROPE BRIDGE DK-DK
9. EYE SPY PANEL
10. 1m CRAWL TUBE
11. HOODED CATERPILLAR SLIDE 1200
12. SAFETY STAIRS DK-DK 800
13. ARC ROOF
14. STEP PANEL & LOOPS x2
15. CATERPILLAR SLIDE 800
16. 800 SWISS CLIMBER
17. PLASTIC OBLIQUE PANEL W/ WHEEL
18. TWISTED CHALLENGE LADDER
19. STEP END DECK

SAFETY ZONE  
SOFT FALL AREA

603 - JASPER  
MAX FHF: 2.2m

SCALE = mm

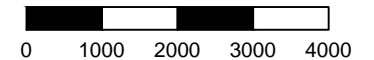

APPROX AREA (sq.m.): 163.3 APPROX PERIMETER (lin.m.): 51.4

603 - JASPER  
EXTREME UNIT  
STANDARD DRAWING

DRAWING No.: 603

REV: A

DRN: R. CROOKE  
DATE: 29/03/18

SCALE 1:100  
SHEET 1 OF 1

SIZE  
A4

- Heights above Playground surface are shown on decks and all play equipment, is. Ⓢ = 40mm
- Impact absorbing ground cover is required under and around all play equipment.
- The min. recommended fall zone around the entire play structure is shown. This zone is to be free of all tripping or collision hazards (i.e. roots, rocks, border material, etc).
- Site layout and dimensions are subject to verification prior to installation.
- Dimensions in millimetres unless stated otherwise.

