

DO NOT SCALE

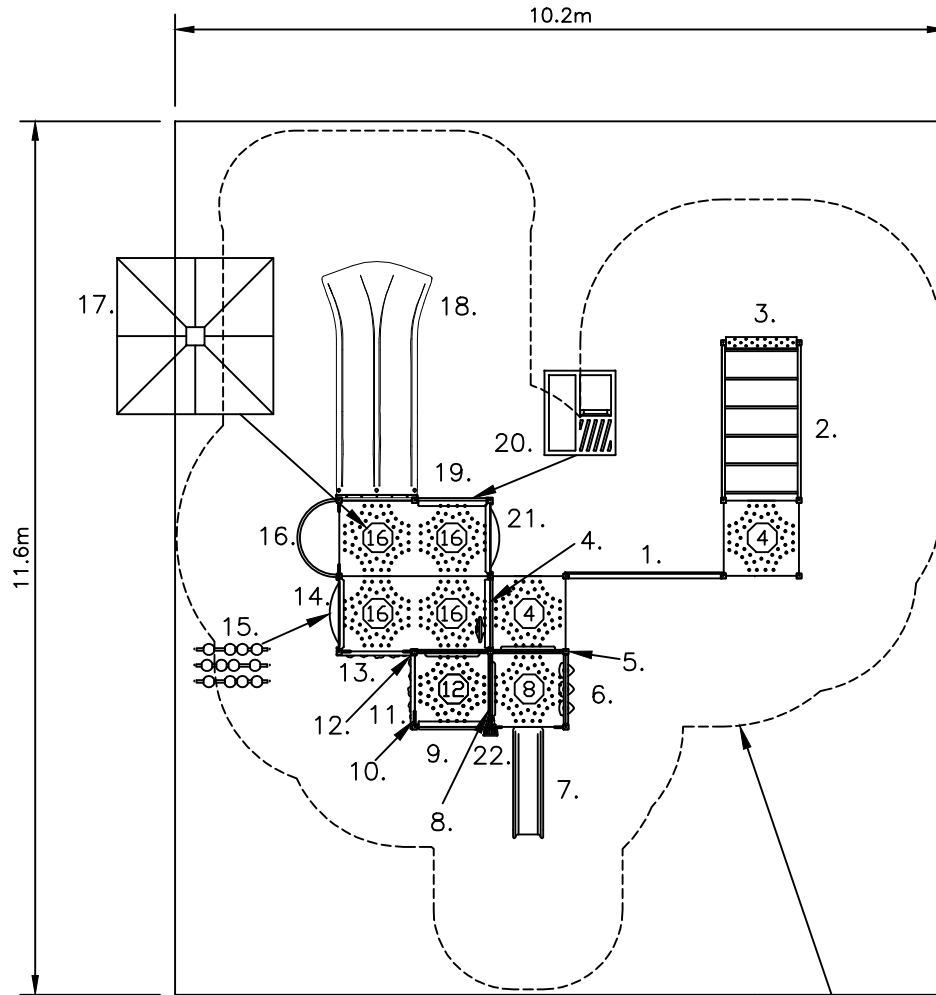

1. SPIDER NET CLIMBER
2. CHALLENGE LADDER
3. STEP END DECK
4. PLASTIC OBLIQUE PANEL W/ WHEEL
5. STEP PANEL & LOOPS
6. NAUGHTS AND CROSSES PANEL
7. CATERPILLAR SLIDE 800
8. STEP PANEL & LOOPS
9. PLASTIC OBLIQUE PANEL
10. DOUBLE D LOOP
11. ROCKWALL CHALLENGE 1200
12. STEP PANEL & LOOPS
13. ROCKWALL CLIMBER 1600
14. BUBBLE PANEL
15. ABACUS PANEL (UNDER)
16. FIREPOLE 1600
17. DOUBLE CASTLE ROOF
18. DOUBLE WIDE SLIDE 1600
19. PLASTIC OBLIQUE PANEL
20. SHOP FRONT PANEL (UNDER)
21. BUBBLE PANEL
22. KALEIDOSCOPE

556-Louis  
MAX FHF: 2.2m

SAFETY ZONE\*

SOFT FALL AREA

SCALE = mm

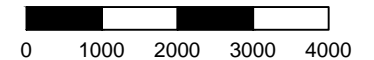

\*AS 4685:2014

APPROX AREA (sq.m.): 120.4 APPROX PERIMETER (lin.m.): 44.0

556 - LOUIS  
EXTREME UNIT  
STANDARD DRAWING

DRAWING No.: 556

REV: A

DRN: R. CROOKE

SCALE 1:100

SIZE

DATE: 03/07/18

SHEET 1 OF 1

A4

- Heights above Playground surface are shown on decks and all play equipment, is. (3) = 400mm
- Impact absorbing ground cover is required under and around all play equipment.
- The min. recommended fall zone around the entire play structure is shown. This zone is to be free of all tripping or collision hazards (i.e. roots, rocks, border material, etc).
- Site layout and dimensions are subject to verification prior to installation.
- Dimensions in millimetres unless stated otherwise.

